

D-Code Washbasin ♂ # 23106000002 / 23106000302

< 23 5/8" Inch >

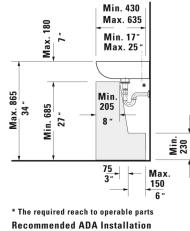

\* The required reach to operable parts  
Recommended ADA Installation

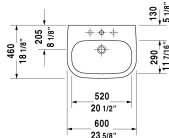
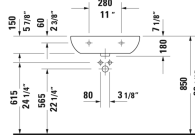
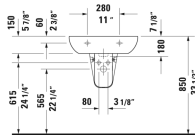
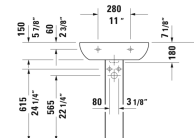

Washbasin	Dimension	Weight	Order number
with overflow, with faucet deck, underside fully glazed, hardware included, wall-mounted, cUPC® listed*, 23 5/8" Inch			
<b>Colors</b>			
00 White			
<b>Variant</b>			
●	23 5/8" x 18 1/8" Inch	39.2 lb	23106000002
●●●	23 5/8" x 18 1/8" Inch	39.2 lb	23106000302
<b>Infobox</b>			
* Complies with following standards: ASME A112.19.2/CSA B45.1, Washbasin is not ADA compliant in combination with pedestal, siphon cover or metal console			
<b>Suitable products</b>			
Siphon cover for # 231065, 231060, 231055, 034265, 034285, 034210, 034812,			085718
Pedestal for # 231065, 231060, 231055, 034265, 034285, 034210, 034812,			086327

All drawings contain the necessary measurements which are subject to standard tolerances. They are stated in inch & mm and are non-binding. Exact measurements, in particular for customized installation scenarios, can only be taken from the finished ceramic piece.