

ME by Starck Furniture washbasin ♂ # 233610..00 / 233610..30
 / 233610..58 / 233610..60 / 233610..00 / 233610..30 /
 233610..58 / 233610..60

< 40 1/2" Inch >

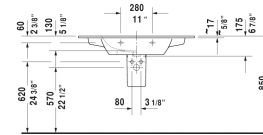
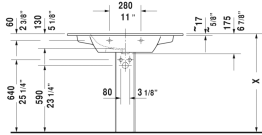
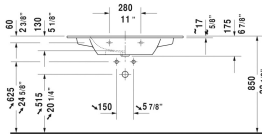
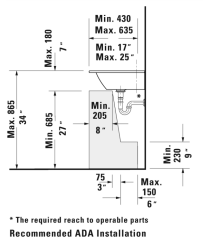
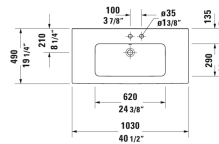
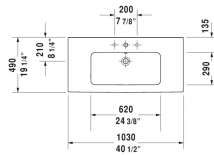

* The required reach to operable parts
 Recommended ADA Installation

Furniture washbasin	Dimension	Weight	Order number
with overflow, with faucet deck, hardware included, wall-mounted, cUPC® listed*, 40 1/2" Inch			

Colors

00 White 32 White Satin Matte

Variant

●	40 1/2" x 19 1/4" Inch	57.3 lb	233610..00
●●●	40 1/2" x 19 1/4" Inch	57.3 lb	233610..30
●●	40 1/2" x 19 1/4" Inch	57.3 lb	233610..58
⊗	40 1/2" x 19 1/4" Inch	57.3 lb	233610..60
●	40 1/2" x 19 1/4" Inch	57.3 lb	233610..00
●●●	40 1/2" x 19 1/4" Inch	57.3 lb	233610..30
●●	40 1/2" x 19 1/4" Inch	57.3 lb	233610..58
⊗	40 1/2" x 19 1/4" Inch	57.3 lb	233610..60

Infobox

* Complies with following standards: ASME A112.19.2/CSA B45.1, Washbasin is not ADA compliant in combination with pedestal, siphon cover or metal console

Sanitary ceramics with the special WonderGliss surface finish will remain clean and attractive-looking for a long time to come.
 When ordering WonderGliss please add a "1" as eleventh digit to the model number.

Space-saving siphon	1 1/4" Inch	0.9 lb	005076
---------------------	-------------	--------	--------

ME by Starck Furniture washbasin # 233610..00 / 233610..30
 / 233610..58 / 233610..60 / 233610..00 / 233610..30 /
 233610..58 / 233610..60

| < 40 1/2" Inch > |

Suitable products		
Vanity unit wall-mounted 1 pull-out compartment, for ME by Starck # 233610, 40 1/8" x 19" Inch	40 1/8" x 19" Inch	LC6142
Vanity unit wall-mounted 2 drawers, upper drawer including cut-out for siphon and siphon cover, for ME by Starck # 233610, 40 1/8" x 19" Inch	40 1/8" x 19" Inch	LC6242
Vanity unit floorstanding 2 pull-out compartments, upper drawer including cut-out for siphon and siphon cover, for ME by Starck # 233610, 40 1/8" x 19" Inch	40 1/8" x 19" Inch	LC6627
Pedestal for # 233565, 233560, 233555, 233613, 233612, 233610, 233683, 233663, 236112, 233653, 6 7/8" x 8 1/4" Inch	6 7/8" x 8 1/4" Inch	085839
Siphon cover for # 233565, 233560, 233555, 233613, 233612, 233610, 233683, 233663, 236112, 233653, 6 3/4" x 11 3/4" Inch	6 3/4" x 11 3/4" Inch	085840
Vanity unit wall-mounted 1 pull-out compartment, for ME by Starck # 233610, 39 3/8" x 18 3/4" Inch	39 3/8" x 18 3/4" Inch	KT6420
Vanity unit wall-mounted 2 drawers, upper drawer including cut-out for siphon and siphon cover, for ME by Starck # 233610, 39 3/8" x 18 3/4" Inch	39 3/8" x 18 3/4" Inch	KT6430
Vanity unit wall-mounted 1 pull-out compartment, for ME by Starck # 233610, 40 1/8" x 18 7/8" Inch	40 1/8" x 18 7/8" Inch	BR4003
Vanity unit wall-mounted 2 drawers, upper drawer including cut-out for siphon and siphon cover, for ME by Starck # 233610, 40 1/8" x 18 7/8" Inch	40 1/8" x 18 7/8" Inch	BR4103
Vanity unit floorstanding 2 pull-out compartments, upper drawer including cut-out for siphon and siphon cover, for ME by Starck # 233610, 40 1/8" x 18 7/8" Inch	40 1/8" x 18 7/8" Inch	BR4403
Vanity unit wall-mounted 1 pull-out compartment, for ME by Starck # 233610, 39 3/4" x 18 7/8" Inch	39 3/4" x 18 7/8" Inch	XS4073
Vanity unit wall-mounted 2 drawers, upper drawer including cut-out for siphon and siphon cover, for ME by Starck # 233610, 39 3/4" x 18 7/8" Inch	39 3/4" x 18 7/8" Inch	XS4173
Vanity unit floorstanding 2 pull-out compartments, upper drawer including cut-out for siphon and siphon cover, integrated legs with height adjustment, for ME by Starck # 233610, 39 3/4" x 18 7/8" Inch	39 3/4" x 18 7/8" Inch	XS4447
Vanity unit wall-mounted 1 pull-out compartment, for ME by Starck # 233610, 39 3/4" x 18 7/8" Inch	39 3/4" x 18 7/8" Inch	XV4027
Vanity unit wall-mounted 2 drawers, upper drawer including cut-out for siphon and siphon cover, for ME by Starck # 233610, 39 3/4" x 18 7/8" Inch	39 3/4" x 18 7/8" Inch	XV4127
Vanity unit floorstanding 2 pull-out compartments, upper drawer including cut-out for siphon and siphon cover, for ME by Starck # 233610, 39 3/4" x 18 7/8" Inch	39 3/4" x 18 7/8" Inch	XV4483

All drawings contain the necessary measurements which are subject to standard tolerances. They are stated in inch & mm and are non-binding. Exact measurements, in particular for customized installation scenarios, can only be taken from the finished ceramic piece.