

DuraSquare Double furniture washbasin # 2353120040 / 2353120041 / 2353120044 / 2353120070

< 47 1/4" Inch >

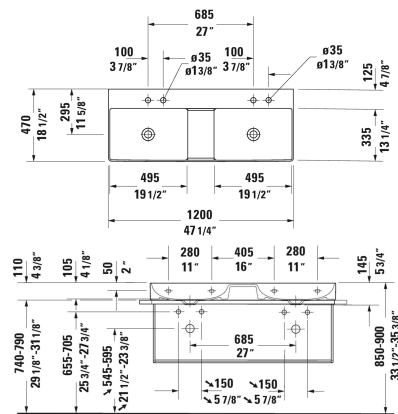
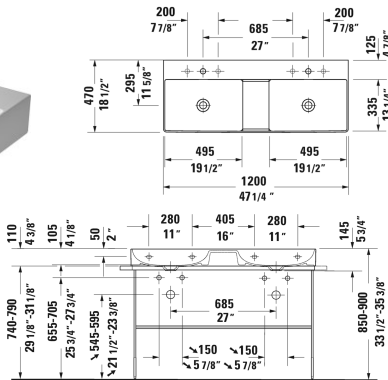
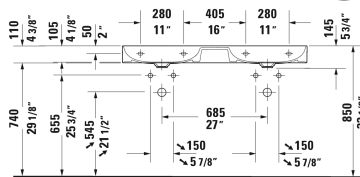

Double furniture washbasin	Dimension	Weight	Order number
without overflow, with faucet deck, ceramic covered slotted waste included, hardware included, underside fully glazed, wall-mounted, 47 1/4" Inch			
Colors			
00 White			
Variant			
● ●	47 1/4" x 18 1/2" Inch	63.9 lb	2353120040
●	47 1/4" x 18 1/2" Inch	63.9 lb	2353120041
● ● ●	47 1/4" x 18 1/2" Inch	63.9 lb	2353120044
☒	47 1/4" x 18 1/2" Inch	63.9 lb	2353120070
Infobox			
Made of DuraCeram			
Sanitary ceramics with the special WonderGliss surface finish will remain clean and attractive-looking for a long time to come. When ordering WonderGliss please add a "1" as eleventh digit to the model number.			
Towel rail square tube 1/2", Chrome, for washbasin # 235312	44 7/8" Inch	1.8 lb	003120
Design Siphon		3.3 lb	005036
Suitable products			
Vanity unit wall-mounted 2 pull-out compartments, for DuraSquare # 235312, 46 5/8" x 18 1/8" Inch	46 5/8" x 18 1/8" Inch		XS4064

**DuraSquare Double furniture washbasin # 2353120040 /
2353120041 / 2353120044 / 2353120070**

|< 47 1/4" Inch >|

Vanity unit wall-mounted 4 drawers, upper drawer including cut-out for siphon and siphon cover, for DuraSquare # 235312, 46 5/8" x 18 1/8" Inch	46 5/8" x 18 1/8" Inch	XS4164
Vanity unit floorstanding 4 pull-out compartments, upper drawer including cut-out for siphon and siphon cover, integrated legs with height adjustment, for DuraSquare # 235312, 46 5/8" x 18 1/8" Inch	46 5/8" x 18 1/8" Inch	XS4456
Metal console floorstanding ** hardware included, for washbasin # 235312, towel rail right or left, reversible, 49 3/4" x 17 3/4" Inch	49 3/4" x 17 3/4" Inch	003117
Metal console wall-mounted ** hardware included, for washbasin # 235312, towel rail right or left, reversible, 49 3/4" x 17 3/4" Inch	49 3/4" x 17 3/4" Inch	003118
Glass inserts safety glass, 45 3/4" x 15" Inch	45 3/4" x 15" Inch	009970

All drawings contain the necessary measurements which are subject to standard tolerances. They are stated in inch & mm and are non-binding. Exact measurements, in particular for customized installation scenarios, can only be taken from the finished ceramic piece.