

**D-Neo Vessel Sink # 2372600070**

| &lt; 23 5/8 " &gt; |

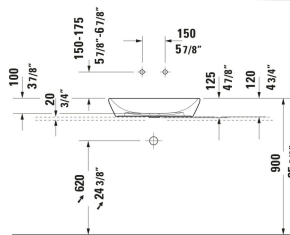
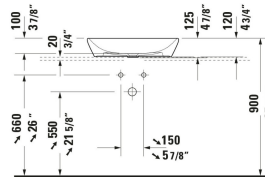
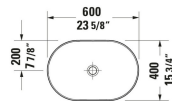

Vessel Sink	Dimension	Weight	Order number
Oval, Includes faucet deck: No, Overflow: No, 23 5/8 "			
<b>Colors</b>			
00 White			
<b>Variant</b>			
☒ White High Gloss, Half oval, Number of basins: 1 Middle	23 5/8 "x4 7/8 "	22.708 lb	2372600070
<b>Spare parts</b>			
Sink Drain Sink, Material drain covers: Brass, Diameter: 2 7/8 "	Ø 2 7/8 "	0.694 lb	005024
P-Trap Material: Brass, Outlet: horizontal, Suitable for Wall Mounted Sink	2 3/4 x 16 3/4 "	3.307 lb	005036
<b>Suitable products</b>			
Vanity Cabinet Number of drawers: 1, Includes vanity top: Yes, Faucet holes possible, Handle, Slow close, Lay-in compartment Optional, 31 1/2 x 21 5/8 "	31 1/2 x 21 5/8 "		DE4947
Vanity Cabinet Number of drawers: 1, Includes vanity top: Yes, Faucet holes possible, Handle, Slow close, Lay-in compartment Optional, 39 3/8 x 21 5/8 "	39 3/8 x 21 5/8 "		DE4948
Vanity Cabinet Number of drawers: 1, Includes vanity top: Yes, Faucet holes possible, Handle, Slow close, Lay-in compartment Optional, 47 1/4 x 21 5/8 "	47 1/4 x 21 5/8 "		DE4949
Vanity Cabinet Number of drawers: 1, Number of drawers: 1, Includes vanity top: Yes, Faucet holes possible, Handle, Siphon cut-out: Yes, Panel: Yes, Slow close, Lay-in compartment Optional, 31 1/2 x 21 5/8 "	31 1/2 x 21 5/8 "		DE4967

**D-Neo Vessel Sink # 2372600070**

|< 23 5/8 " >|

<p>Vanity Cabinet Number of drawers: 1, Number of drawers: 1, Includes vanity top: Yes, Faucet holes possible, Handle, Siphon cut-out: Yes, Panel: Yes, Slow close, Lay-in compartment Optional, 39 3/8 x 21 5/8 "</p>	<p>39 3/8 x 21 5/8 "</p>	<p>DE4968</p>
<p>Vanity Cabinet Number of drawers: 1, Number of drawers: 1, Includes vanity top: Yes, Faucet holes possible, Handle, Siphon cut-out: Yes, Panel: Yes, Slow close, Lay-in compartment Optional, 47 1/4 x 21 5/8 "</p>	<p>47 1/4 x 21 5/8 "</p>	<p>DE4969</p>

*All drawings contain the necessary measurements which are subject to standard tolerances. They are stated in inch & mm and are non-binding. Exact measurements, in particular for customized installation scenarios, can only be taken from the finished ceramic piece.*