

NOTES:

- (NI) 1. FIT / FORM / FUNCTION SHALL FOLLOW PS-E.008.
- △ 2. PUT THESE ITEMS IN SEPARATE PLASTIC BAGS.
- △ 3. TORQUE TO 7.5-8.5 LB-FT.
- △ 4. APPLY THIN COAT OF SILICON GREASE FOR ALL O-RINGS BEFORE INSTALLATION.
- △ 5. APPLY LOCTITE 242, IF SCREW DOES NOT HAVE NYLON PATCH.
- △ 6. APPLY LOCTITE 680.
- △ 7. APPLY SILICONE GREASE 10" FROM OUTLET OF PN 11877A

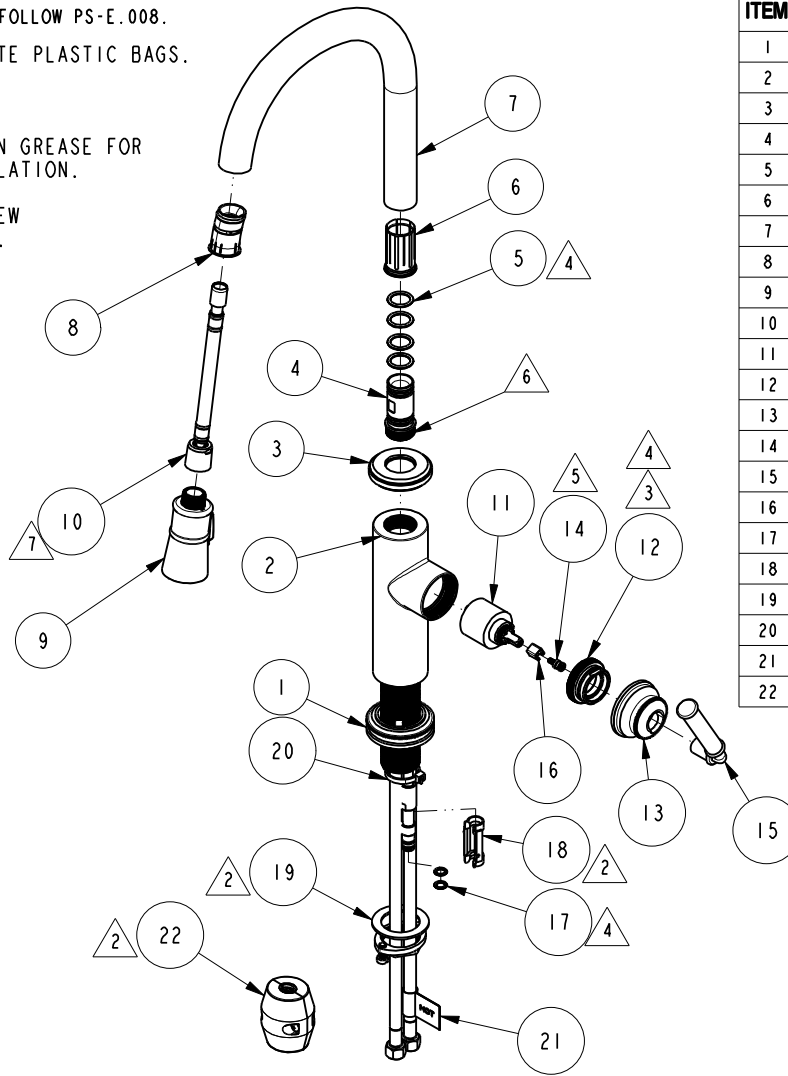

BILL OF MATERIAL (CURRENT LEVEL)

ITEM	PT/ASSY	DESCRIPTION	TYPE	QTY.
1	20-153	BASE RING ASM	ASSEMBLY	1
2	2-782	MAIN BODY ASM, EAST LINEAR	ASSEMBLY	1
3	12446	COLLAR	PART	1
4	12751	SPOUT ADAPTER	PART	1
5	91030	O-RING, #2- 115, EPDM, 65-75 DURO, NSF 61	PART	4
6	91712	SLEEVE	PART	1
7	12475	SPOUT, TAFT PULL-DOWN	PART	1
8	91544	MAGNET DOCKING	ASSEMBLY	1
9	3-571	SPRAY HEAD, TAFT	ASSEMBLY	1
10	11877A	HOSE, PULLDOWN, GREY	ASSEMBLY	1
11	1-064	SINGLE LEVER CARTRIDGE	PART	1
12	1-266	CART. RETAINER ASM	ASSEMBLY	1
13	12837	HANDLE HUB	PART	1
14	11874	HANDLE ADAPTER SCREW	PART	1
15	20-315	HANDLE LEVER ASM	ASSEMBLY	1
16	91534	CARTRIDGE STEM INSERT	PART	1
17	91255	O-RING, #2- 011, EPDM, 65-75 DURO, NSF-61	PART	2
18	91568	RETAINER CLIP	PART	1
19	1-256	MOUNTING KIT	ASSEMBLY	1
20	91341	ZIP TIE	PART	1
21	98044	LABEL - HOT	PART	1
22	1-286A	WEIGHT	ASSEMBLY	1

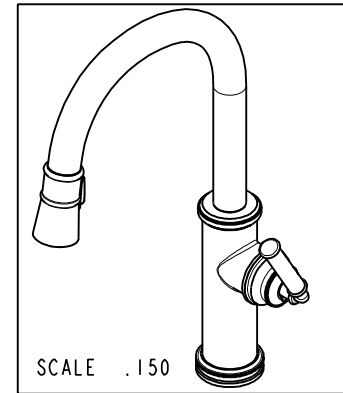

-	E	EN-4066	01/10/20	C.G.
-	D	EN-3931B	09/16/19	V.V.
-	C	EN-3413h	04/26/18	JM
-	B	EN-3413c	01/10/18	JM
-	A	EN-3034L	09/08/17	J.A
-	-	EN-2980	02/11/16	V.V.
ZONE	REV	DESCRIPTION	DATE	APPROVED

COPYRIGHT 2005 BRASSTECH, INC. THESE DRAWINGS AND THE DESIGNS DEPICTED HEREIN ARE THE PROPRIETARY PROPERTY OF BRASSTECH. ANY USE OR REPRODUCTION IS SUBJECT TO THE EXPRESS APPROVAL OF BRASSTECH. UNAUTHORIZED USE IS STRICTLY PROHIBITED. ALL RIGHTS RESERVED.

TESTING	-	-	-
ASSEMBLY	-	-	-
PLATING	-	-	-
POLISHING	-	NEXT ASSY	USED ON
MACHINING	-	APPLICATION	
TOOLING FIXTURE #	REMOVE ALL BURRS AND SHARP EDGES		

UNITS ARE: INCHES [MM]
TOLERANCES ARE:
FRACTIONS DECIMALS ANGLES
±1/16" .X ±.1 [2.5] ±1°
.XX ±.06 [1.5]

(X.XXX) DENOTES CRITICAL DIMS.
ALL THREADS ARE CRITICAL

DRAWN	JINSON	01/10/20
CHECKED	C.G.	01/10/20
APPROVED	C.G.	01/10/20

BRASSTECH 2001 CARNEGIE AVE.
INCORPORATED SANTA ANA, CA 92705
(949) 417-5207

PULL DOWN KITCHEN FAUCET
- TAFT

DWG NO.	2940-5103	REV	E
SCALE	.150	REF.	-
SHEET	1	OF	2

