

NOTES:

1. TO INSPECT ASSEMBLY, FOLLOW FIRST ARTICLE AND IN PROCESS INSPECTION SHEET.

2. APPLY THIN COAT OF SILICON GREASE ON O-RINGS.

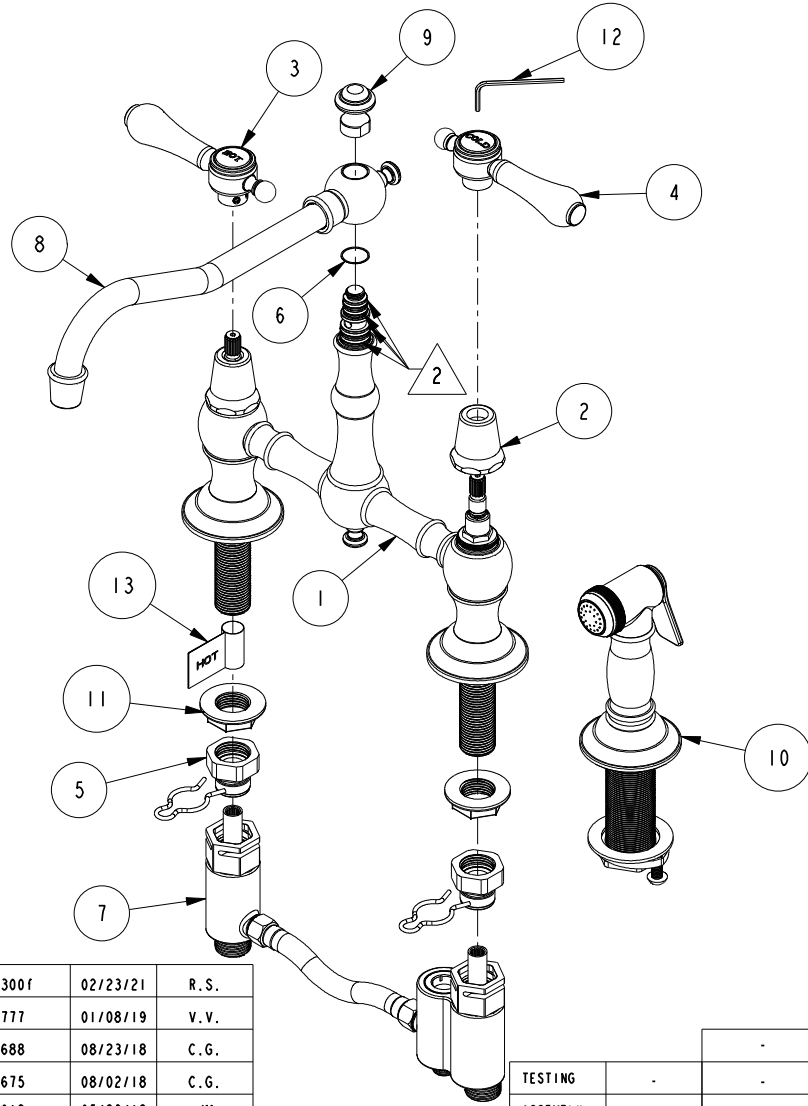

BILL OF MATERIAL (CURRENT LEVEL)

| ITEM | PT/ASSY | DESCRIPTION | TYPE | QTY. |
|------|---------|--|----------|------|
| 1 | 3-300 | KITCHEN BRIDGE BODY ASM W/ SPRAY | ASSEMBLY | 1 |
| 2 | 12259 | HANDLE BONNET - TUB FILLER | PART | 2 |
| 3 | 2-134 | HANDLE ASSEMBLY - HOT | ASSEMBLY | 1 |
| 4 | 2-133 | HANDLE ASSEMBLY - COLD | ASSEMBLY | 1 |
| 5 | 1-152 | SEAT ASSY, UPPER | ASSEMBLY | 2 |
| 6 | 91012 | WSHR, .595 ID X .656 OD X .01 THK, FLT | PART | 1 |
| 7 | 2-472 | DIVERTER ASSY, BRIDGE FAUCET | ASSEMBLY | 1 |
| 8 | 3-299 | KITCHEN SPOUT ASSY | ASSEMBLY | 1 |
| 9 | 10318 | FINIAL, NUT | PART | 1 |
| 10 | 129 | KITCHEN SPRAY HEAD | ASSEMBLY | 1 |
| 11 | 91061 | FLANGE NUT 1/2-14 NPSM | PART | 2 |
| 12 | 10159 | HEX KEY, 3/32 ALLOY STEEL | PART | 1 |
| 13 | 98044 | LABEL - HOT | PART | 1 |

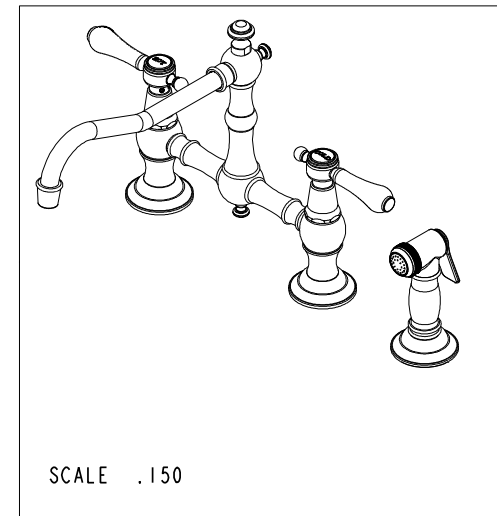

SCALE .150

| - | G | EN-4300f | 02/23/21 | R.S. |
|------|-----|-------------|----------|----------|
| - | F | EN-3777 | 01/08/19 | V.V. |
| - | E | EN-3688 | 08/23/18 | C.G. |
| - | D | EN-3675 | 08/02/18 | C.G. |
| - | C | EN-3612 | 05/23/18 | JM |
| - | B | EN-2909 | 06/19/17 | AN |
| - | A | EN-1919a | 08/12/14 | VV |
| - | - | EN-2805 | 08/28/13 | - |
| ZONE | REV | DESCRIPTION | DATE | APPROVED |

COPYRIGHT 2005 BRASSTECH, INC. THESE DRAWINGS AND THE DESIGNS DEPICTED HEREIN ARE THE PROPRIETARY PROPERTY OF BRASSTECH. ANY USE OR REPRODUCTION IS SUBJECT TO THE EXPRESS APPROVAL OF BRASSTECH. UNAUTHORIZED USE IS STRICTLY PROHIBITED. ALL RIGHTS RESERVED.

| | | | |
|-------------------|----------------------------------|-------------|---------|
| TESTING | - | - | - |
| ASSEMBLY | - | - | - |
| PLATING | - | - | - |
| POLISHING | - | NEXT ASSY | USED ON |
| MACHINING | - | APPLICATION | |
| TOOLING FIXTURE # | REMOVE ALL BURRS AND SHARP EDGES | | |

| | |
|--------------------------------|-----------------|
| UNITS ARE: INCHES [MM] | |
| TOLERANCES ARE: | |
| FRACTIONS | DECIMALS ANGLES |
| ±1/16" | .X ±.1 [2.5] ±" |
| | .XX ±.06 [1.5] |
| (X.XXX) DENOTES CRITICAL DIMS. | |
| ALL THREADS ARE CRITICAL | |
| DRAWN | AN 05/18/17 |
| CHECKED | AN 05/18/17 |
| APPROVED | AN 05/18/17 |

BRASSTECH 2001 CARNEGIE AVE.
INCORPORATED SANTA ANA, CA 92705
(949) 417-5207

**KITCHEN BRIDGE FAUCET W/
SPRAY**

DWG NO. **9462** REV **G**

SCALE .225 REF. - SHEET | OF 2

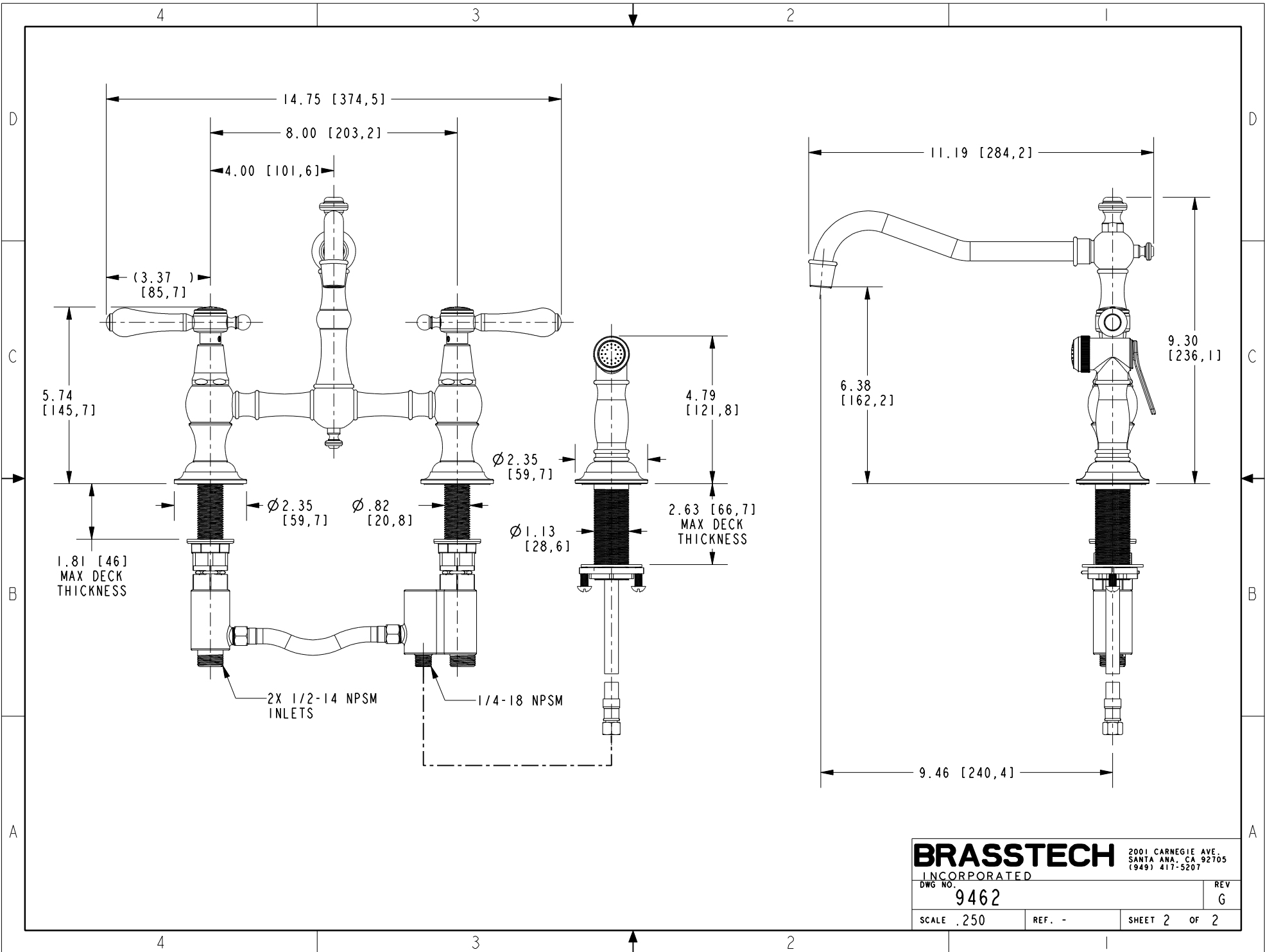

BRASSTECH 2001 CARNEGIE AVE.
 INCORPORATED SANTA ANA, CA 92705
 (949) 417-5207

| | | | |
|---------|------|------|---|
| DWG NO. | 9462 | REV | G |
| SCALE | .250 | REF. | - |
| SHEET 2 | | OF 2 | |