

# INSTALLATION INSTRUCTIONS

## Decorative Wall Bar

Part #'s: 9624, 9630, 9636

# JACLO®

Confidence from start to finish.™



# PARTS

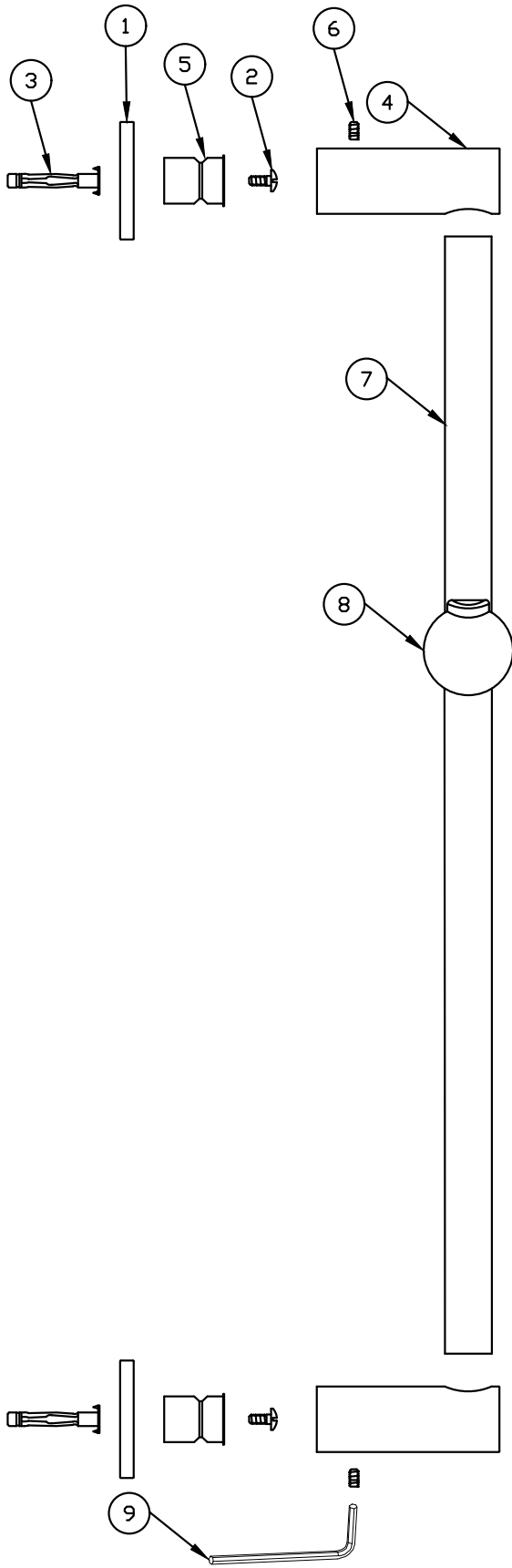

	COMPONENT PARTS	QTY.
1	ESCUTCHEON	2
2	SCREW	2
3	WALL ANCHOR	2
4	POST	2
5	MOUNTING BRACKET	2
6	SET SCREW	2
7	BAR	1
8	SLIDER	1
9	ALLEN KEY	1

## POSITIONING OF WALL BAR

1. Determine convenient height for placement of wall bar

## PREPARING FOR INSTALLATION

1. Temporarily put bar onto top & bottom post and measure the distance from center post to center post.
2. Mark desired location with top & bottom post measurement, ensuring that vertical bar is even.
3. Remove mounting hardware from posts.
4. Drill 1 hole 1/4" diameter on top position.
5. Repeat for bottom.
6. Using provided mounting post and screws, secure into wall where marking is located.
7. Place escutcheons over mounting post and nipple against wall.
8. Place wall bar against escutcheons.
9. Once proper fit is achieved, tighten set screws securely.

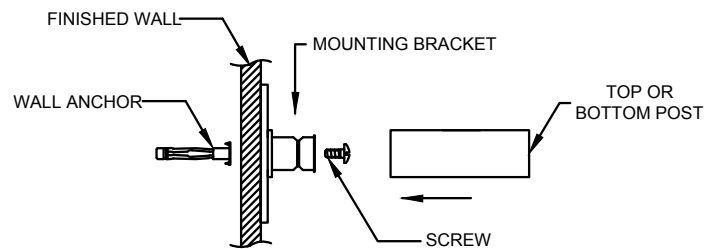

## INSTALLING HOSE & HANDSHOWER

1. Screw hose on to bottom threads.  
(Nut end to supply, conical end to handshower)
2. Insert handshower into the slide mechanism.
3. Adjust the height of handshower by simply pressing the button on top of slider and sliding to your desired height.

To learn more about JACLO's warranty, please visit [\*\*jaclo.com\*\*](http://jaclo.com)