

SPECIFICATIONS

36" PALOMAR VANITY TOP WITH INTEGRAL SINK

NativeStone® Collection

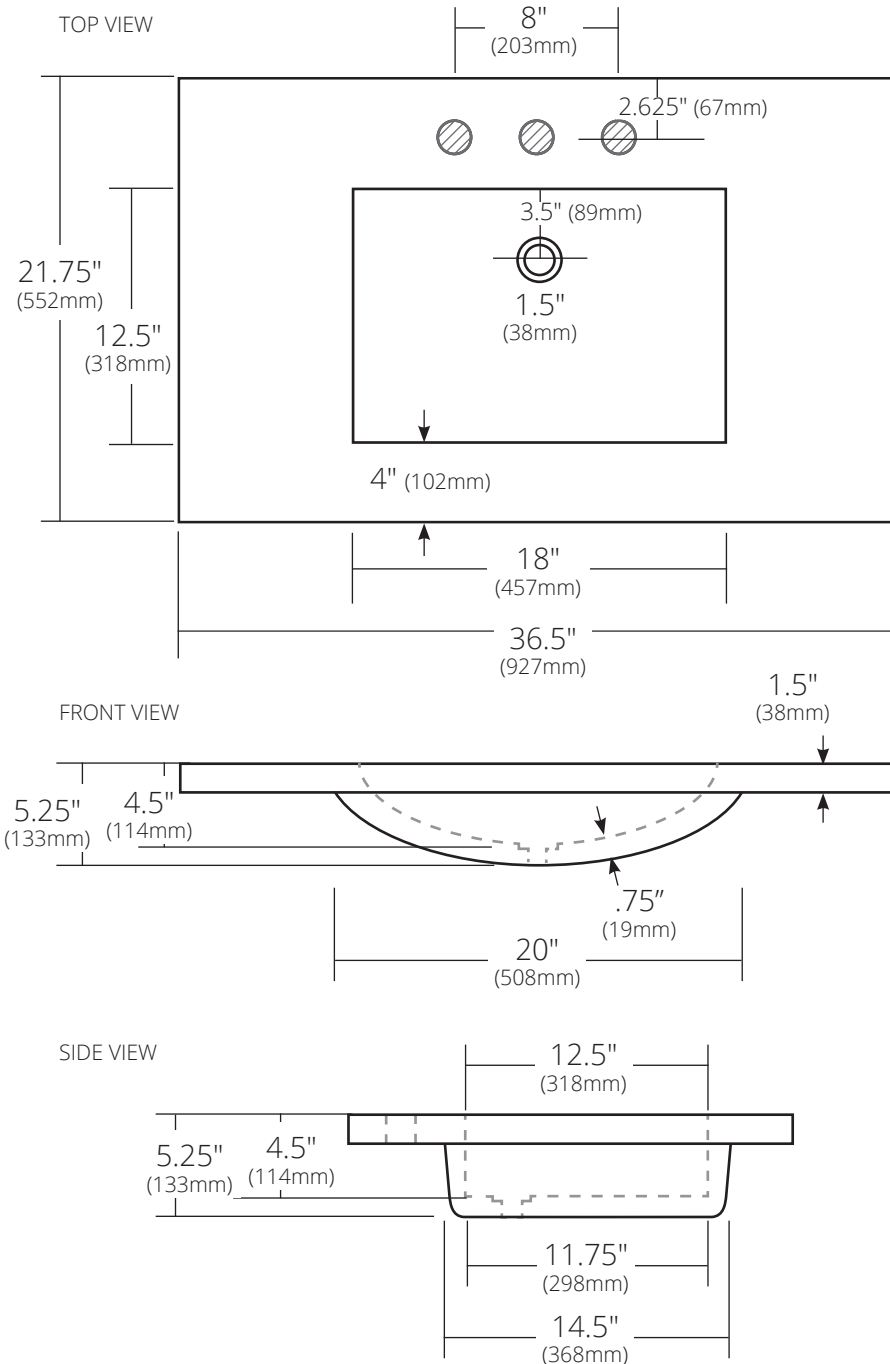
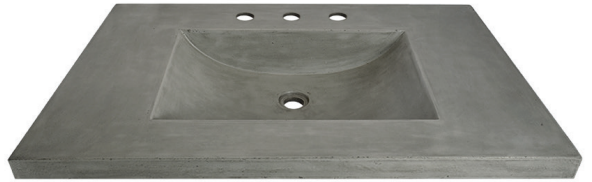

- | | |
|--|--|
| <ul style="list-style-type: none"> 8" Faucet Spread NSVNT36-A Ash NSVNT36-S Slate NSVNT36-P Pearl NSVNT36-E Earth | <ul style="list-style-type: none"> Single Faucet Hole NSVNT36-A1 Ash NSVNT36-S1 Slate NSVNT36-P1 Pearl NSVNT36-E1 Earth |
|--|--|

PRODUCT DETAILS

- 36.5" x 21.75" x 5.25" OD (927mm x 552mm x 133mm)
- Basin 18" x 12.5" x 4.5" (457mm x 318mm x 114mm)
- 1.5" (38mm) drain opening
- Pre-drilled for 8" (203mm) faucet spread or single faucet hole
- Handcrafted from sustainable NativeStone®
- Sealed with impermeable nano sealer

COORDINATING PRODUCTS

- Drains: DR120, DR130 or DR150
- NativeStone® Sealer

STANDARDS COMPLIANCE

- UPC/cUPC compliant
- **ADA COMPLIANT**

IMPORTANT

Do NOT use tape or other adhesives on NativeStone® as it may remove the sealer.

Due to the handcrafted nature of this product, it will vary in finish, texture, and other details. Dimensions may vary up to 1/4" (6mm).