

# Saturna 6036 Acrylic Drop-in Bathtub

**Model number:**

106167-003-001

**Dimensions:** 60" x 36" x 20"

**Installation:** Drop-in

**Material:** Acrylic



## Standard Features:

- Oval shape bathtub
- Drop-in installation
- End drain
- No skirt available

## Product characteristics:

- Made in North America
- Elegant Design
- Comfortable Backrest

## Systems:

- Whirlpool
- Combined Whirlpool/Aeroeffect
- Aeroeffect

## Standard Colors:



White (001)



Bone (004)

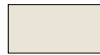

Biscuit (007)

## Certifications

MAAX products adhere to one or more of the following certifications:



# MAAX

# Saturna 6036 Acrylic Drop-in Bathtub

**Model number:**

106167-003-001

**Dimensions:** 60" x 36" x 20"

**Installation:** Drop-in

**Material:** Acrylic

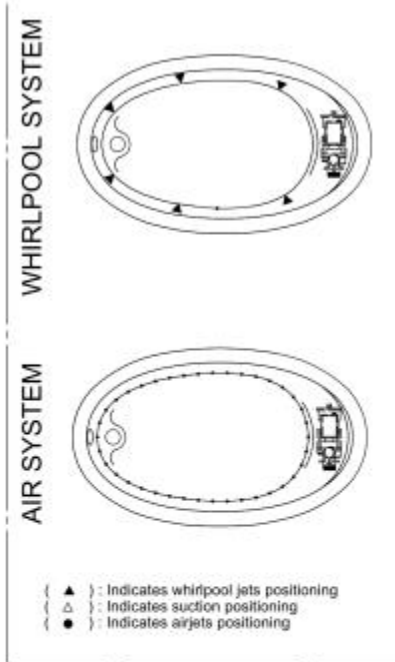
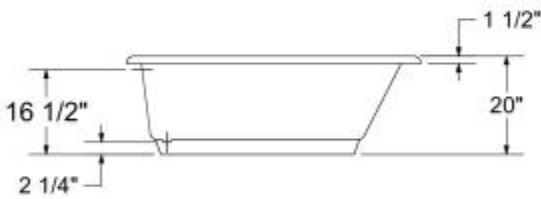
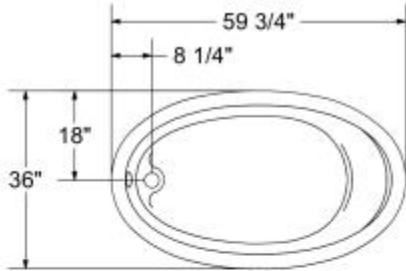

## Dimensions

60 x 36 x 20 In.  
(1524 x 914 x 508 mm)

## Water Capacity

55 gallons - 209 liters

## Weight

90 lbs - 40 3/4 kg

## Bathing Well

54 1/4 In. x 28 3/4 In.

## Deep Sump Height

17 In. - 432 mm

## Deck Width

2.875 In. - 73 mm

## Drain location:

Center

All dimensions are approximate.  
Structure measurement must be verified against the unit to ensure proper fit.

Project: \_\_\_\_\_

Contractor: \_\_\_\_\_

Representative: \_\_\_\_\_

Date: \_\_\_\_\_

Tel: \_\_\_\_\_

Notes: \_\_\_\_\_

# MAAX