

QZBS-1816 16 x 18 Granite Dual Mount Bar Sink

Model number:

QZ01816BS.077

Dimensions: 16" x

Installation: Drop In

Material: Granite

Standard Features:

- Contemporary design applied to classic sink features.
- Ideal as a kitchen island sink.
- Virtually indestructible - will not damage from kitchen use.
- Made with 80% actual quartz stone.
- Offers design flexibility - install as drop-in or undermount.

Product characteristics:

- Drop-in
- Modern Design
- Remodeling or New Construction

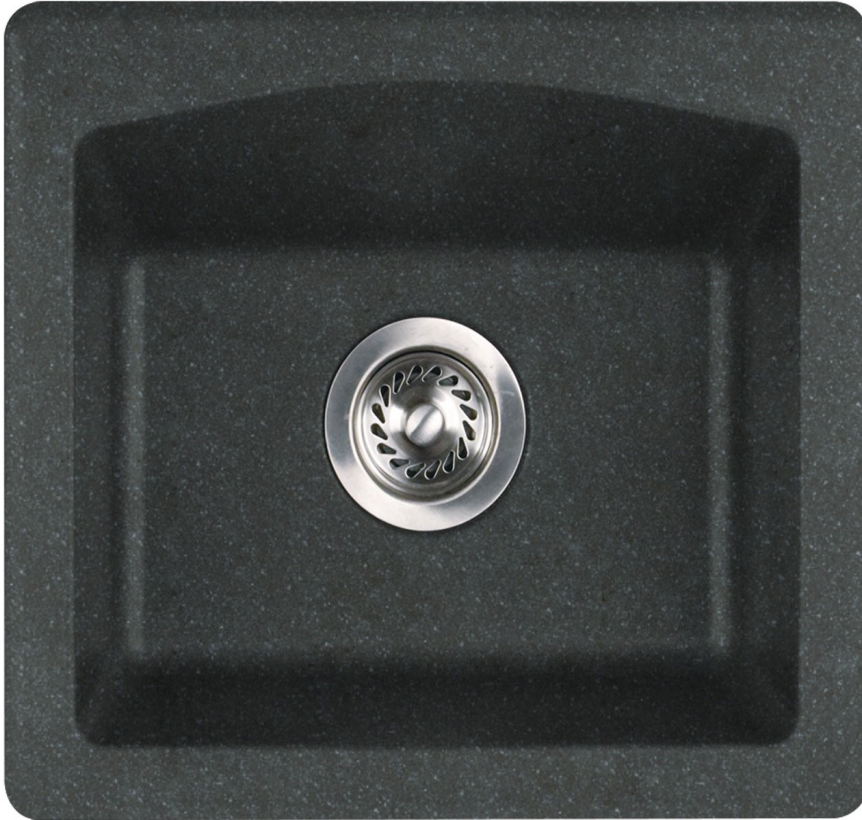

Standard Colors:



Opal White

Certifications

SWAN products adhere to one or more of the following certifications:



QZBS-1816 16 x 18 Granite Dual Mount Bar Sink

Model number:

QZ01816BS.077

Dimensions: 16" x

Installation: Drop In

Material: Granite

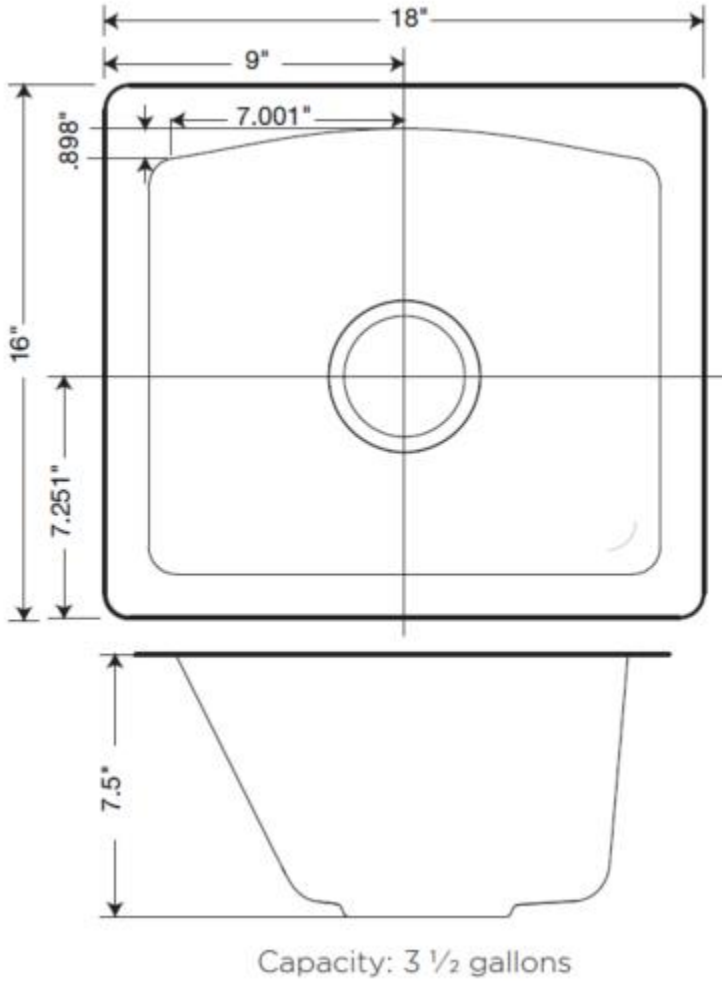

Dimensions

16 x
(406 x)

Type Of Bowl

Single

Type Of Sink

Kitchen

Number Of Bowls

One

Project:

Contractor:

Representative:

Date:

Tel:

Notes:

